



ReelROVER

Quick Start Guide



by cerrowire.com



GEARBOX PARK SETTING (TOP)

- Drive wheels are locked by placing both gearboxes in **PARK** so they will not rotate, locking the entire unit in place.
- The reel will rotate freely.
- Ideal for locking the unit in place while paying out wire.
- Place both gearboxes in **PARK** anytime leaving the ReelRover unattended.

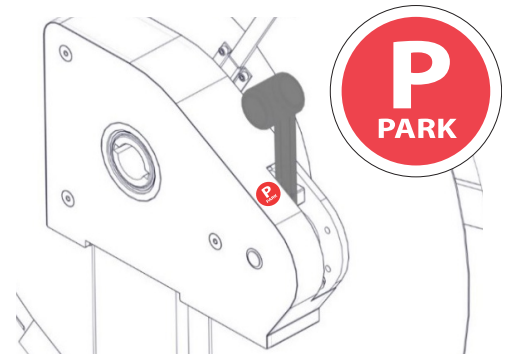

GEARBOX NEUTRAL SETTING (CENTER)

- ReelRover moves like a cart by placing both gearboxes in **NEUTRAL**.
- No mechanical advantage.
- Ideal for moving unit over long distances on flat ground.
- **NEVER** use the **NEUTRAL** setting on grades.
- **DO NOT** leave the ReelRover unattended while in **NEUTRAL**.

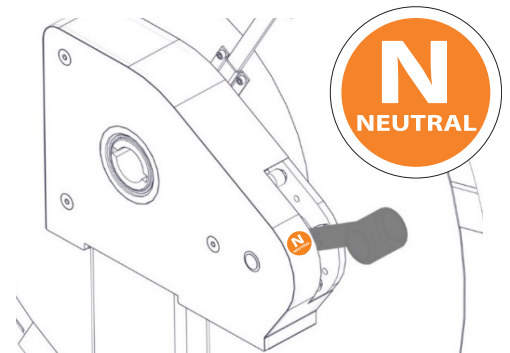

GEARBOX DRIVE SETTING (BOTTOM)

- Drive wheels rotate only when the reel is rotated with both gearboxes placed in **DRIVE**.
- ReelRover may be driven by manually rotating the reel.
- Ideal for moving over job-site debris and controlling the speed of the unit while moving down a grade.

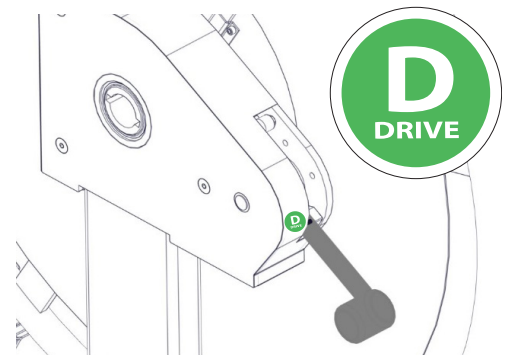

For technical questions, please contact Cerrowire at 800.367.2906 or reelrover@cerrowire.com.

GEARBOX DRIVE GUIDELINES

- The drive wheels will rotate in the same direction as the reel.
- The reel may be rotated from any side of the ReelRover on flat ground.
- If the reel is manually prevented from rotating, the drive wheels will also be prevented from rotating.

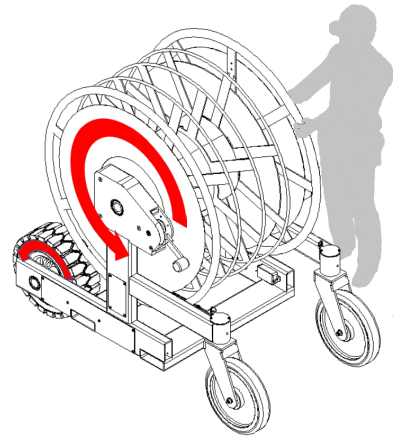

- If one gearbox is placed in **PARK** and the other in **DRIVE**, the unit will perform a driven turn about the parked wheel when the reel is rotated.
- Ideal for maneuvering the unit when fully loaded or in tight spaces.

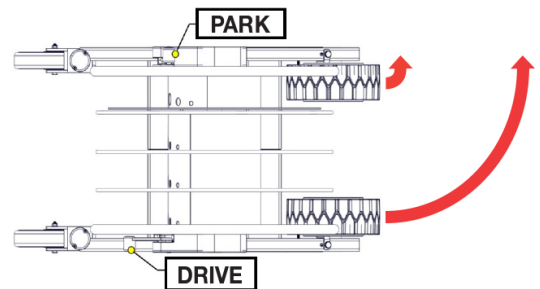

- Both gearboxes always must be placed in **DRIVE** before the ReelRover is operated on a grade; the unit always must be controlled on a grade.
- The unit should never be turned on a grade.
- The caster wheels must be downgrade regardless of direction of travel on a grade.

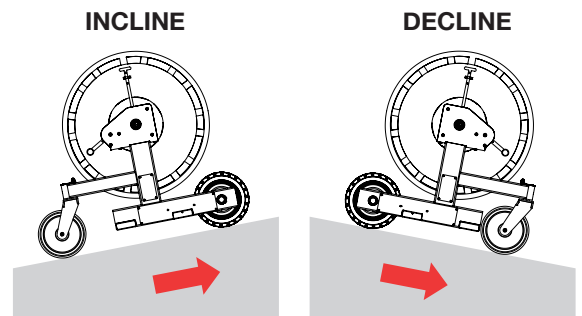

FREE-SPINNING GROUND LOCK

- When pulled/unlocked the free-spinning ground will rotate independently of the conductor reel.
- Ideal for paying out the ground wire at the same rate as the conductor wire.
- Lock must be engaged when moving the ReelRover in **NEUTRAL** or **DRIVE**.



Scan to access online ReelRover resources, including demonstration videos, manuals, and the equipment checklist.